

REVISIONS

REV	DATE	BY	APP	DESCRIPTION OF REVISION
99	14 FEB 22	GH		DRAWING CREATED

NOTES

OVERVIEW	
TEMPERATURE:	-40°C TO -80°C ± 5.0°C VOL. UNIFORMITY -20°C ± 5.0°C VOL. UNIFORMITY UNCONDITIONED ANTEROOM PRODUCT AT TEMPERATURE WHEN LOADED INTO FREEZER, NO PRODUCT LOAD ASSUMED
PRODUCT:	
L.T. FREEZER STORAGE:	108 FT ³ PER SIDE 212 FT ³ TOTAL 848 FT ³ PER SIDE, 1,696 FT ³ TOTAL AT 8'-0" (HEIGHT) OF STORAGE
CONDENSERS:	WATER-COOLED
DOOR OPENING:	-20°C = 15 SECONDS
DOOR RECOVER TIME:	-20°C = 3 MINUTES (OPEN TO ANTEROOM) L.T. FREEZER = 30 SECOND
ARCHITECTURAL	
PANEL FINISH:	INTERIOR/EXTERIOR = EMBOSSED GALVANIZED STEEL PRE-PAINTED WHITE
DOOR SIZE:	3'-0" WIDE X 7'-6" TALL (ANTEROOM) 3'-0" WIDE X 8'-0" TALL (-20°C CORRIDOR) 3'-0" WIDE X 8'-0" TALL (LOW TEMP STORAGE FREEZER)
FM 4880:	OUTSIDE CHAMBER ONLY (4" PANELS)
FLOOR RATING:	600 LBS/SQ.FT.
CEILING RATING:	15 LBS/SQ.FT. (5 LBS/SQ.FT. DEAD LOAD/ 10 LBS/SQ.FT. LIVE LOAD)
MECHANICAL	
REFRIGERATION:	REDUNDANT MECHANICAL REFRIGERATION SYSTEM FOR -20°C AND LOW TEMP. FREEZER CHAMBERS.
PIPING:	MAX. DISTANCE FROM SKID TO CHAMBER NOT TO EXCEED 50' HORIZ/50' VERTICAL
ELECTRICAL	
CONTROLS:	ALLEN-BRADLEY COMPACTLOGIX PLC (NON-REDUNDANT)
CONTROL PANELS:	NEMA 4-1/2 (GRAY)
LIGHTING:	LED LIGHTING
SAFETY PERSON-IN-BOX:	TIMED OCCUPANCY ALARM OF CORRIDOR
PERSONNEL ALARM:	EMERGENCY PUSH-BUTTON LOCATED IN THE CORRIDOR AT THE DOOR LOCATION 16" A.F.F.
OPTIONS	
PANEL FINISH:	304 STAINLESS STEEL INTERIOR OR EXTERIOR
FLOOR RATING:	1,000 LBS/SQ.FT. (OVERLAY)
RAMP:	DIAMOND TREAD OR NON-SKID STRIPS
CEILING RATING:	20 LBS/SQ.FT.
FM 4880:	OPTION TO NOT INCLUDE
SHELVING:	CUSTOMER TO SPECIFY NUMBER OF TIERS & IF COIL GUARD IS PREFERRED.
AIR-COOLED CONDENSERS:	OPTIONAL IF WATER IS NOT AVAILABLE.
LOW RISE DEFROST:	OPTIONAL FOR CORRIDOR (-20°C) ONLY.
CONDENSATE PUMP:	OPTIONAL TERTIARY BACKUP INCLUDES OXYGEN MONITOR INSIDE THE CORRIDOR AND AT THE LN2 VALVE RACK.
LN2:	LN2 VALVE RACK
CONTROL PANEL:	NEMA 4X
UPS BACKUP:	CONTROLS ONLY (20 MINUTE)
EMERGENCY LIGHTING:	BATTERY BACKUP YOKOGAWA
RECORDER:	
ALARM CONTACTS - FORM-C (N.C./N.O.) CONNECTION BY OTHERS	
-20°C CORRIDOR	<ul style="list-style-type: none">HIGH TEMPERATURE DEVIATIONLOW TEMPERATURE DEVIATIONHIGH TEMPERATURE LIMITLOW TEMPERATURE LIMITDOOR ALARMEVAPORATOR FAN FAILURE (SYSTEM 1)EVAPORATOR FAN FAILURE (SYSTEM 2)CONDENSER FAILURE (SYSTEM 1)CONDENSER FAILURE (SYSTEM 2)PERSONNEL/PERSON-IN-BOX ALARM
LOW TEMP. FREEZER	<ul style="list-style-type: none">HIGH TEMPERATURE DEVIATIONLOW TEMPERATURE DEVIATIONHIGH TEMPERATURE LIMITLOW TEMPERATURE LIMITDOOR ALARMCONDENSER FAILURE (SYSTEM 1)CONDENSER FAILURE (SYSTEM 2)
LN2 (OPTION)	<ul style="list-style-type: none">O2 ALARMLN2 EMERGENCY VALVE CLOSEDLN2 ACTIVELN2 OFFLINE
NOTES:	<ol style="list-style-type: none">THE MAXIMUM DESIGN NOISE LEVEL OF THE EQUIPMENT MAY EXCEED 80 DBA, MEASURED AT 3'-0" AWAY.REFRIGERANT RELIEF PIPING IF REQUIRED IS BY OTHERS.CONDENSATE DRAIN CONNECTION TO BE WITHIN 10' OF THE CHAMBER.

© Copyright Notice:
This Drawing is protected by copyright laws. Reproduction and distribution of the Drawing is prohibited without written consent from Environmental Specialties, L.L.C. (ES) or the possessing party has contractual binding / working agreement with ES on this project.

THIS DRAWING IS TO BE USED IN CONJUNCTION WITH PROJECT SUBMITTAL TEXT FOR COMPLETE CHAMBER DETAILS.

ENVIRONMENTAL SPECIALTIES

4412 TRYON RD.
RALEIGH, NC 27806

STANDARD MODEL
10 DOOR ULTRA-LOW

APPROVED BY: DATE CREATED: 14 FEB 22
DESIGNED BY: BAHN - 10D
DRAWING NUMBER: 00

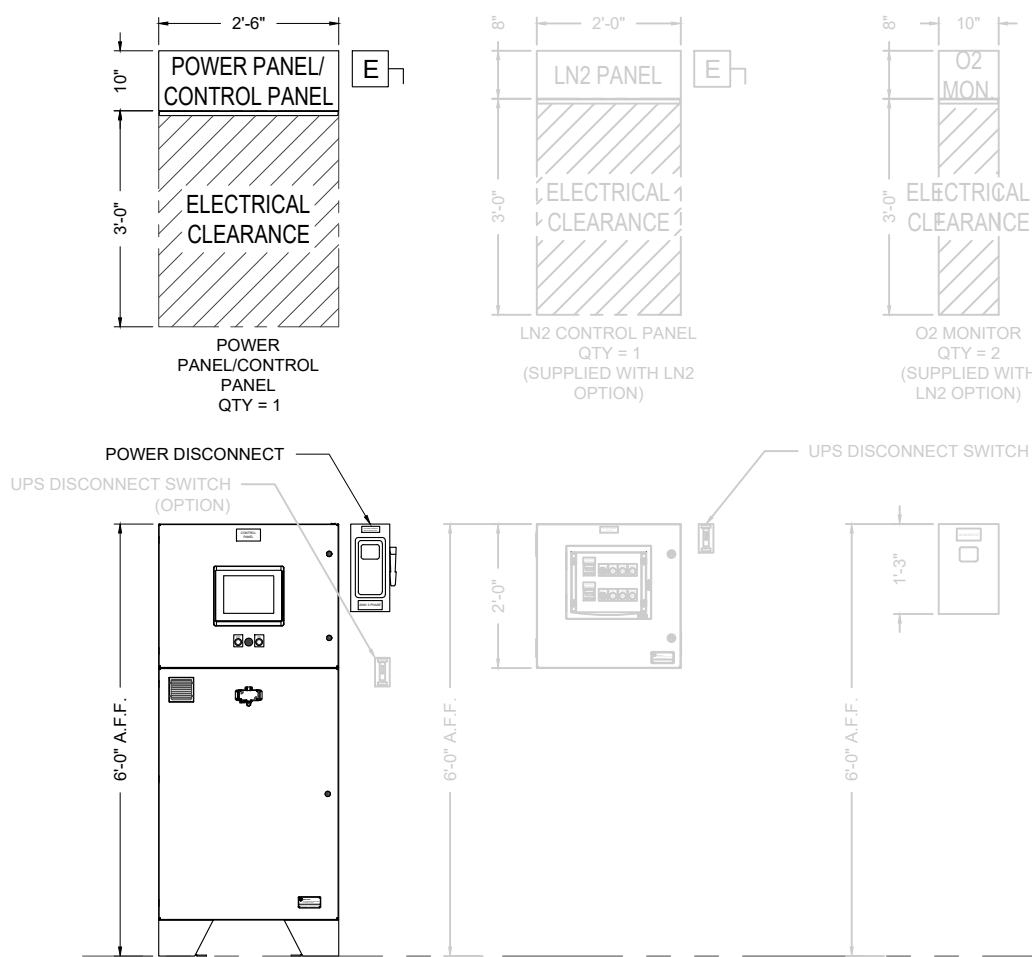
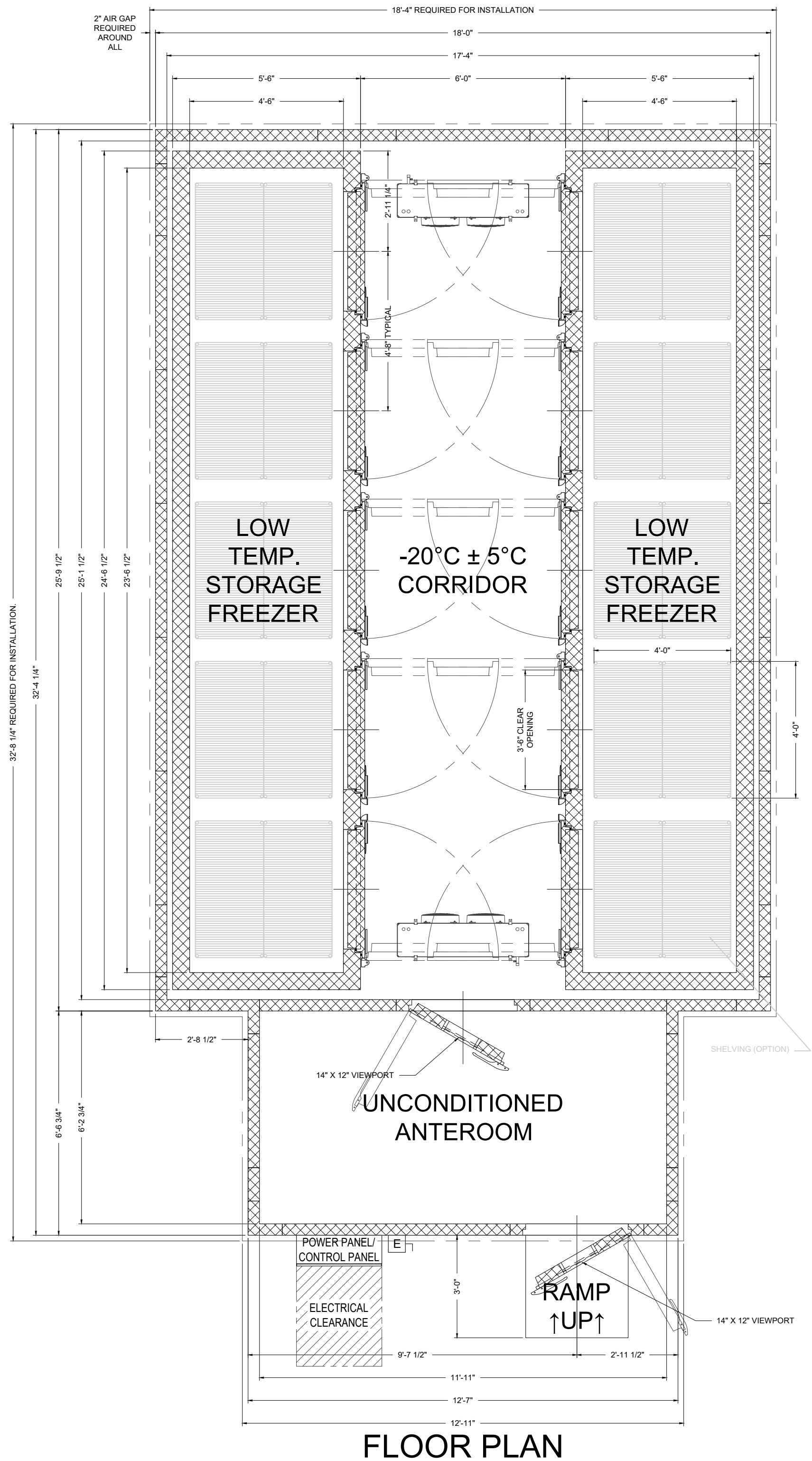

CONTROL PANELS

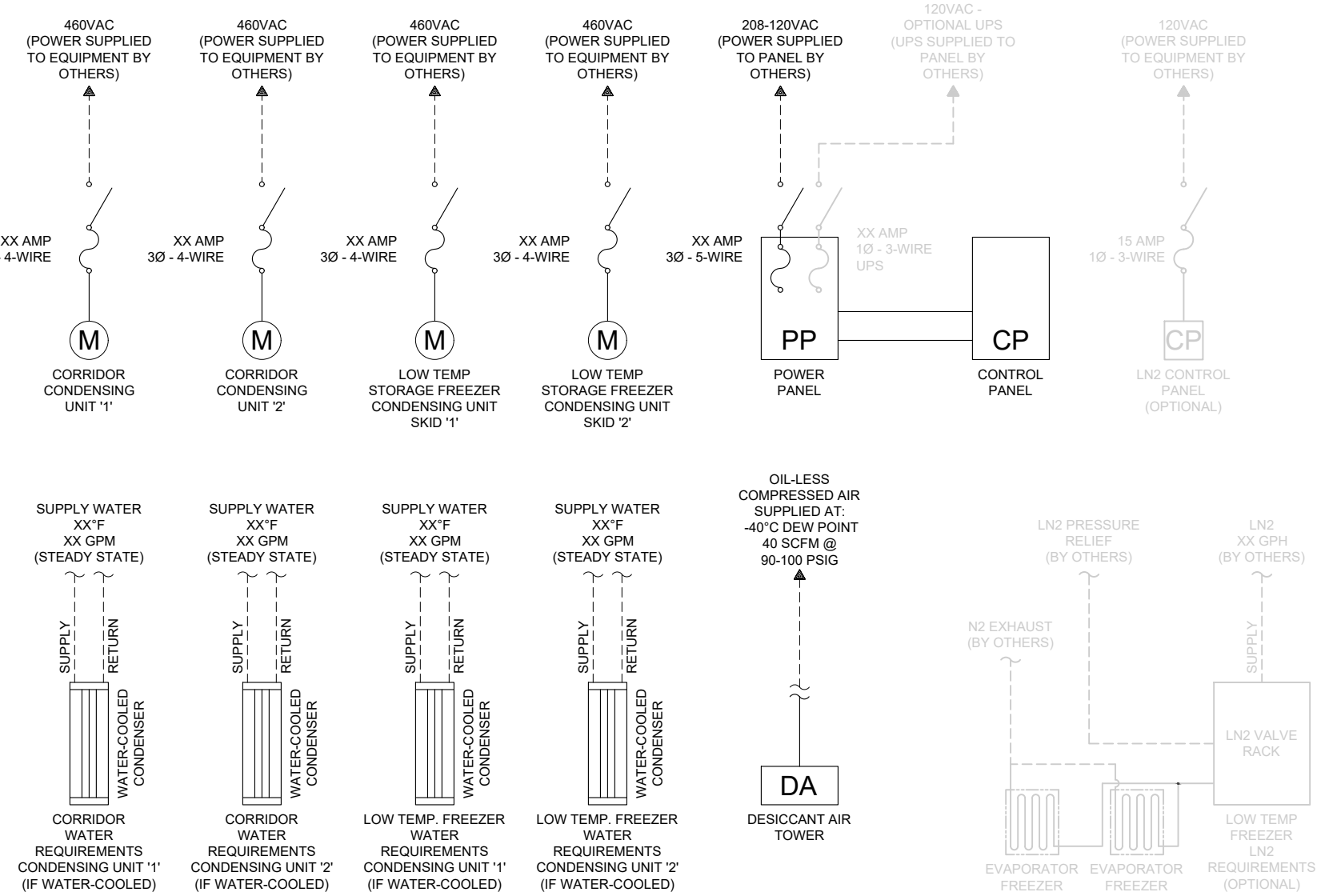

UTILITIES

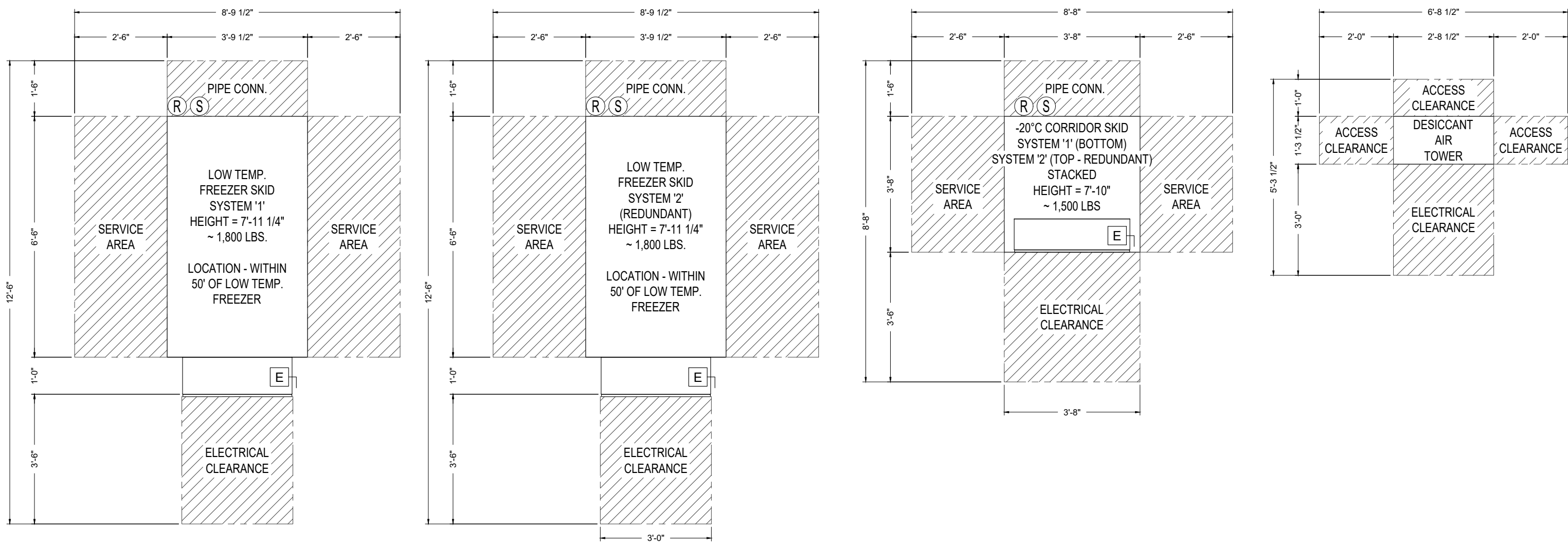

EQUIPMENT SIZE

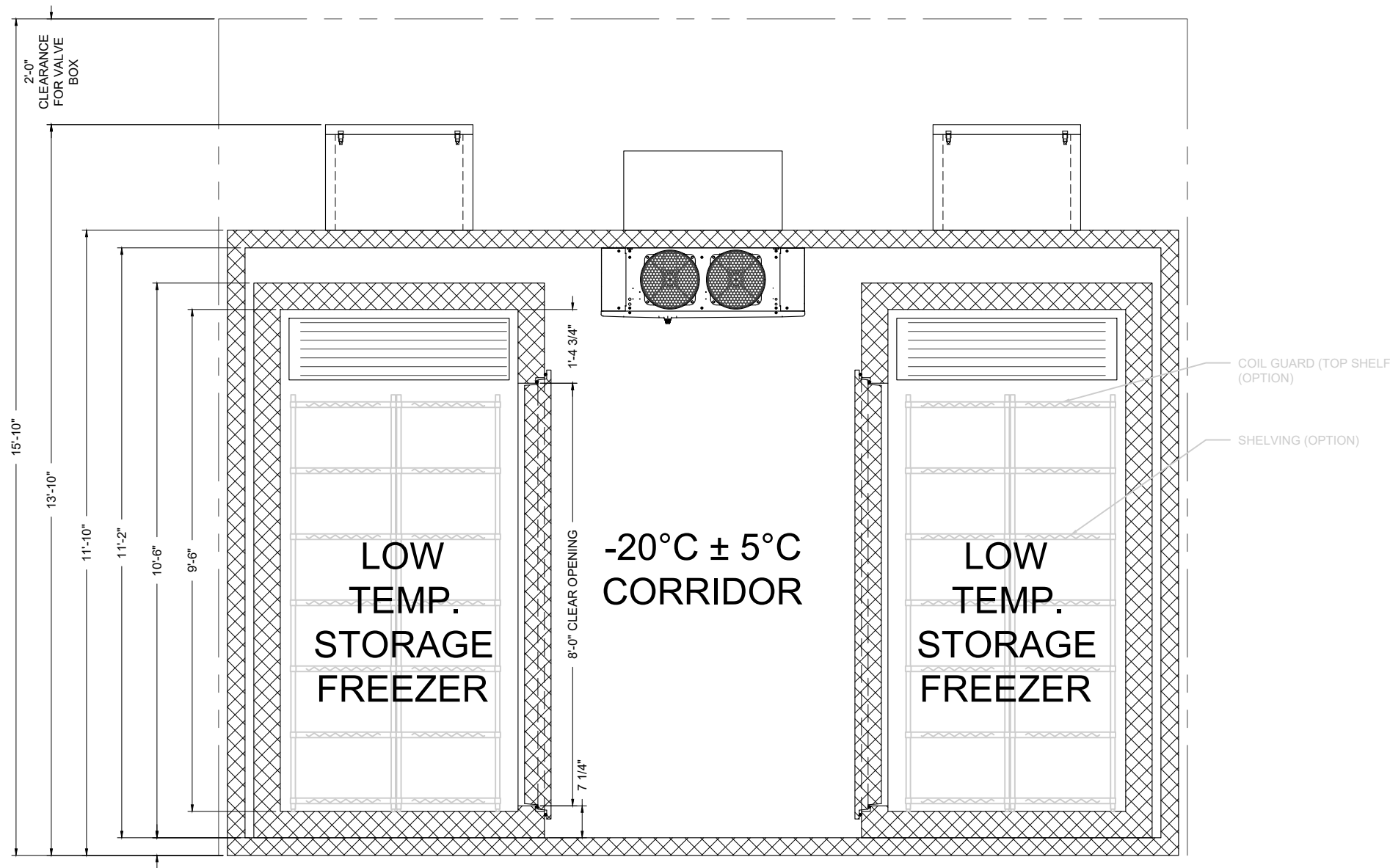

ELEVATION VIEW