

REVISIONS				
REV	DATE	BY	APP	DESCRIPTION OF REVISION
00	14 FEB 22	GH		DRAWING CREATED

NOTES	
OVERVIEW	

TEMPERATURE: -40°C TO -80°C ± 5.0°C VOL. UNIFORMITY
-20°C ± 5.0°C VOL. UNIFORMITY UNCONDITIONED ANTEROOM
PRODUCT: PRODUCT AT TEMPERATURE WHEN LOADED INTO FREEZER. NO PRODUCT LOAD ASSUMED
L.T. FREEZER STORAGE: 85 FT³ PER SIDE 170 FT³ TOTAL
680 FT³ PER SIDE, 1,360 FT³ TOTAL AT 8'-0" (HEIGHT) OF STORAGE
CONDENSERS: WATER-COOLED
DOOR OPENING: -20°C = 15 SECONDS
-20°C = 30 SECONDS
DOOR RECOVER TIME: -20°C = 3 MINUTES (OPEN TO ANTEROOM)
L.T. FREEZER = 3 MIN. (OPEN TO -20°C)

ARCHITECTURAL
PANEL FINISH: INTERIOR/EXTERIOR = EMBOSSED GALVANIZED STEEL PRE-PAINTED WHITE
DOOR SIZE: 3'-0" WIDE X 7'-6" TALL (ANTEROOM)
3'-0" WIDE X 7'-6" TALL (-20°C CORRIDOR)
3'-0" WIDE X 8'-0" TALL (LOW TEMP STORAGE FREEZER)
FM 4880: OUTSIDE CHAMBER ONLY (4" PANELS)
FLOOR RATING: 600 LBS/SQ.FT.
CEILING RATING: 15 LBS/SQ.FT. (5 LBS/SQ.FT. DEAD LOAD/ 10 LBS/SQ.FT. LIVE LOAD)

MECHANICAL
REFRIGERATION: REDUNDANT MECHANICAL REFRIGERATION SYSTEM FOR -20°C AND LOW TEMP. FREEZER CHAMBERS.
PIPING: MAX. DISTANCE FROM SKID TO CHAMBER NOT TO EXCEED 50' HORIZ./50' VERTICAL

ELECTRICAL
CONTROLS: ALLEN-BRADLEY COMPACTLOGIX PLC (NON-REDUNDANT)
CONTROL PANELS: NEMA 412 (GRAY)
LIGHTING: LED LIGHTING

SAFETY
PERSON-IN-BOX: TIMED OCCUPANCY ALARM OF CORRIDOR
PERSONNEL ALARM: EMERGENCY PUSH-BUTTON LOCATED IN THE CORRIDOR AT THE DOOR LOCATION 16" A.F.F.

OPTIONS
PANEL FINISH: 304 STAINLESS STEEL INTERIOR OR EXTERIOR
FLOOR RATING: 1,000 LBS/SQ.FT. (OVERLAY)
RAMP: DIAMOND TREAD OR NON-SKID STRIPS
CEILING RATING: 20 LBS/SQ.FT.
FM 4880: OPTION TO NOT INCLUDE CUSTOMER TO SPECIFY NUMBER OF TIERS & IF COIL GUARD IS PREFERRED.
AIR-COOLED CONDENSERS: OPTIONAL IF WATER IS NOT AVAILABLE.
LOW RISE DEFROST: OPTIONAL FOR CORRIDOR (-20°C) ONLY.
CONDENSATE PUMP: OPTIONAL
LN2: TERTIARY BACKUP INCLUDES OXYGEN MONITOR INSIDE THE CORRIDOR AND AT THE LN2 VALVE RACK.
CONTROL PANEL: NEMA 4X
UPS BACKUP: CONTROLS ONLY (20 MINUTE)
EMERGENCY LIGHTING: BATTERY BACKUP YOKOGAWA
RECORDER:

ALARM CONTACTS - FORM-C (N.C./N.O.) CONNECTION BY OTHERS

-20°C CORRIDOR
• HIGH TEMPERATURE DEVIATION
• LOW TEMPERATURE DEVIATION
• HIGH TEMPERATURE LIMIT
• LOW TEMPERATURE LIMIT
• DOOR AJAR
• EVAPORATOR FAN FAILURE (SYSTEM 1)
• EVAPORATOR FAN FAILURE (SYSTEM 2)
• CONDENSER FAILURE (SYSTEM 1)
• CONDENSER FAILURE (SYSTEM 2)
• PERSONNEL/PERSON-IN-BOX ALARM

LOW TEMP. FREEZER
• HIGH TEMPERATURE DEVIATION
• LOW TEMPERATURE DEVIATION
• HIGH TEMPERATURE LIMIT
• LOW TEMPERATURE LIMIT
• DOOR AJAR
• CONDENSER FAILURE (SYSTEM 1)
• CONDENSER FAILURE (SYSTEM 2)

LN2 (OPTION)
• O2 ALARM
• LN2 EMERGENCY VALVE CLOSED
• LN2 ACTIVE
• LN2 OFFLINE

NOTES:
1. THE MAXIMUM DESIGN NOISE LEVEL OF THE EQUIPMENT MAY EXCEED 80 DBA, MEASURED AT 3'-0" AWAY.
2. REFRIGERANT RELIEF PIPING IF REQUIRED IS BY OTHERS.
3. CONDENSATE DRAIN CONNECTION TO BE WITHIN 10' OF THE CHAMBER.

© Copyright Notice:
This Drawing is protected by copyright laws. Reproduction and distribution of the Drawing is prohibited without written consent from Environmental Specialties, L.L.C. (ES) or the possessing party has contractual binding / working agreement with ES on this project.

THIS DRAWING IS TO BE USED IN CONJUNCTION WITH PROJECT SUBMITTAL TEXT FOR COMPLETE CHAMBER DETAILS.

ENVIRONMENTAL SPECIALTIES			
4412 TRYON RD. RALEIGH, NC 27806		DRAWN BY: HERR SCALE: 3/8" = 1'-0"	
STANDARD MODEL 8 DOOR ULTRA-LOW			
APPROVED BY:	DRAWN BY:	DATE CREATED:	REVISION:
		14 FEB 22	BAHN - 08D 00

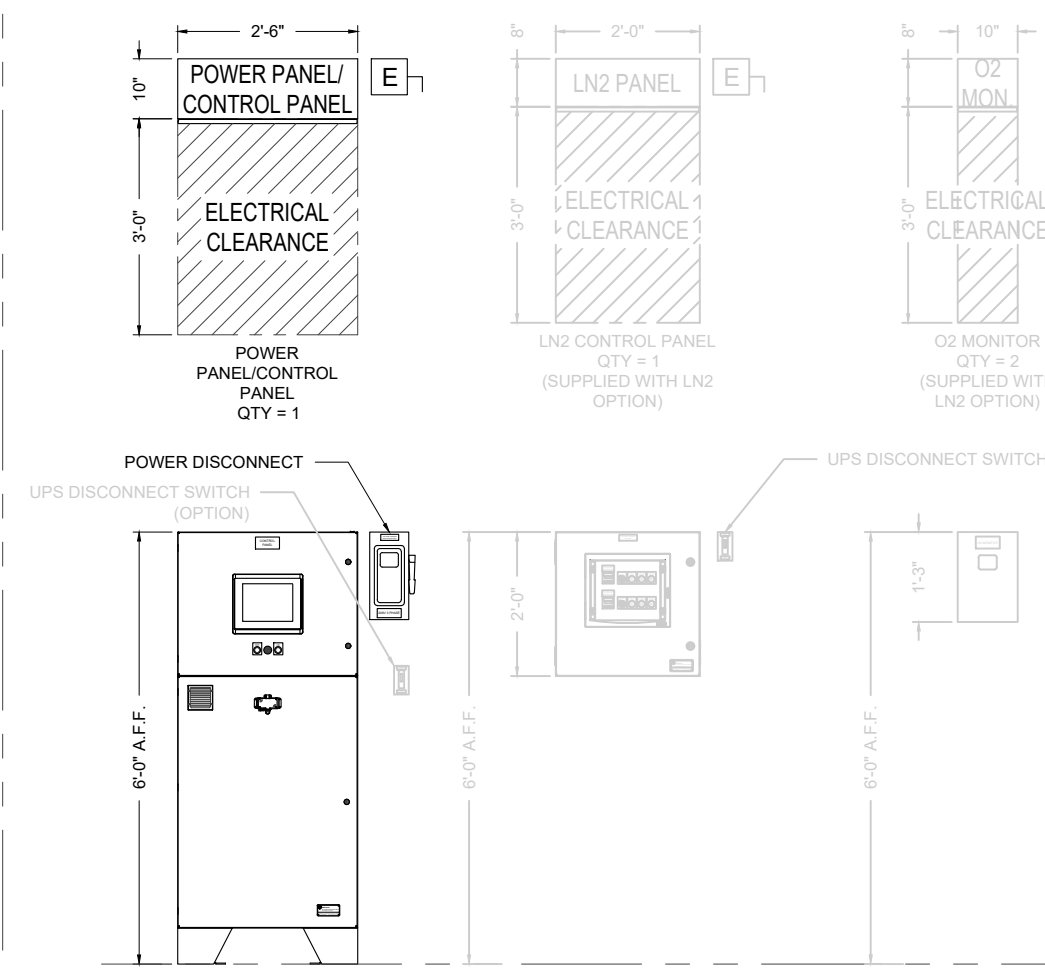
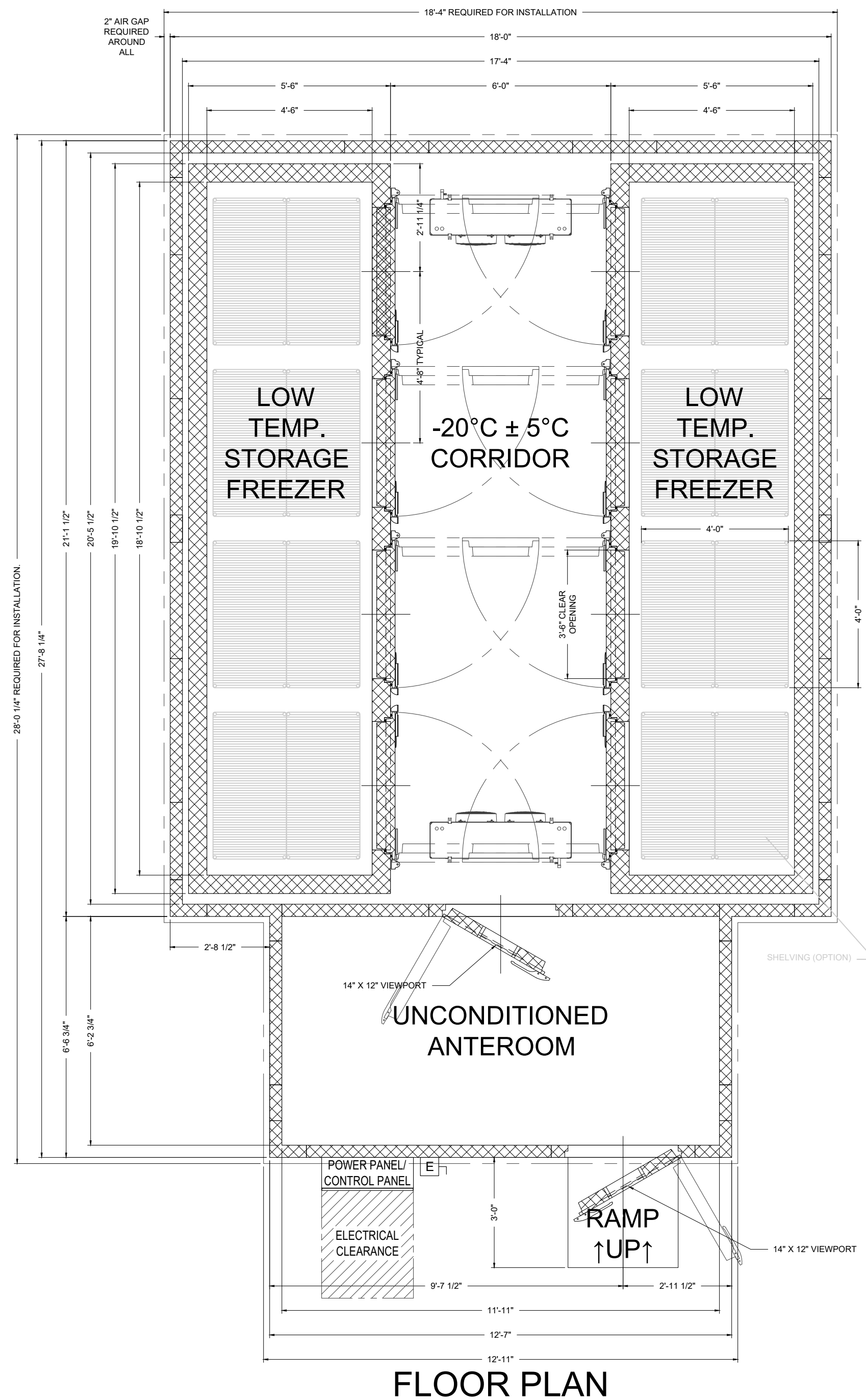

CONTROL PANELS

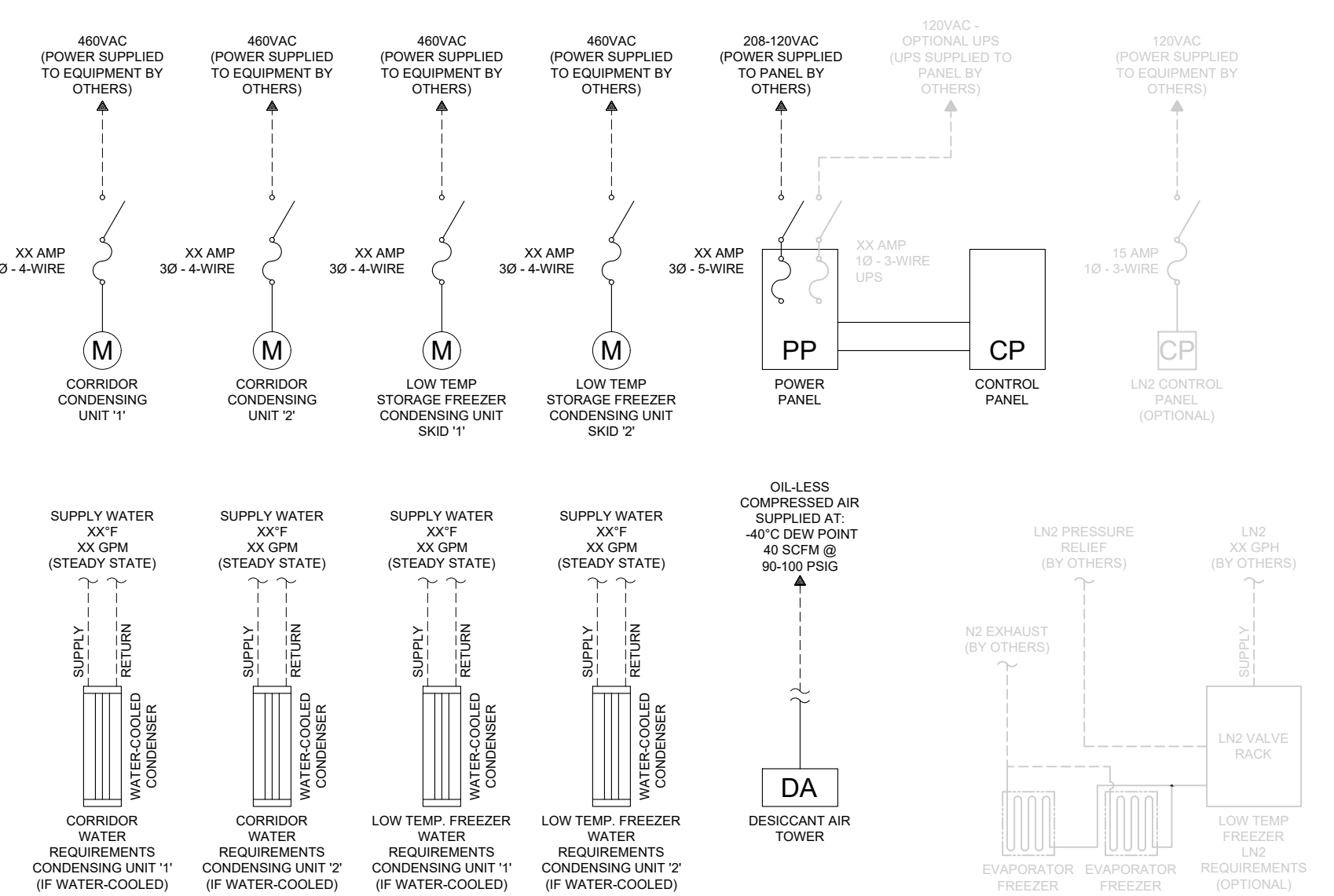

UTILITIES

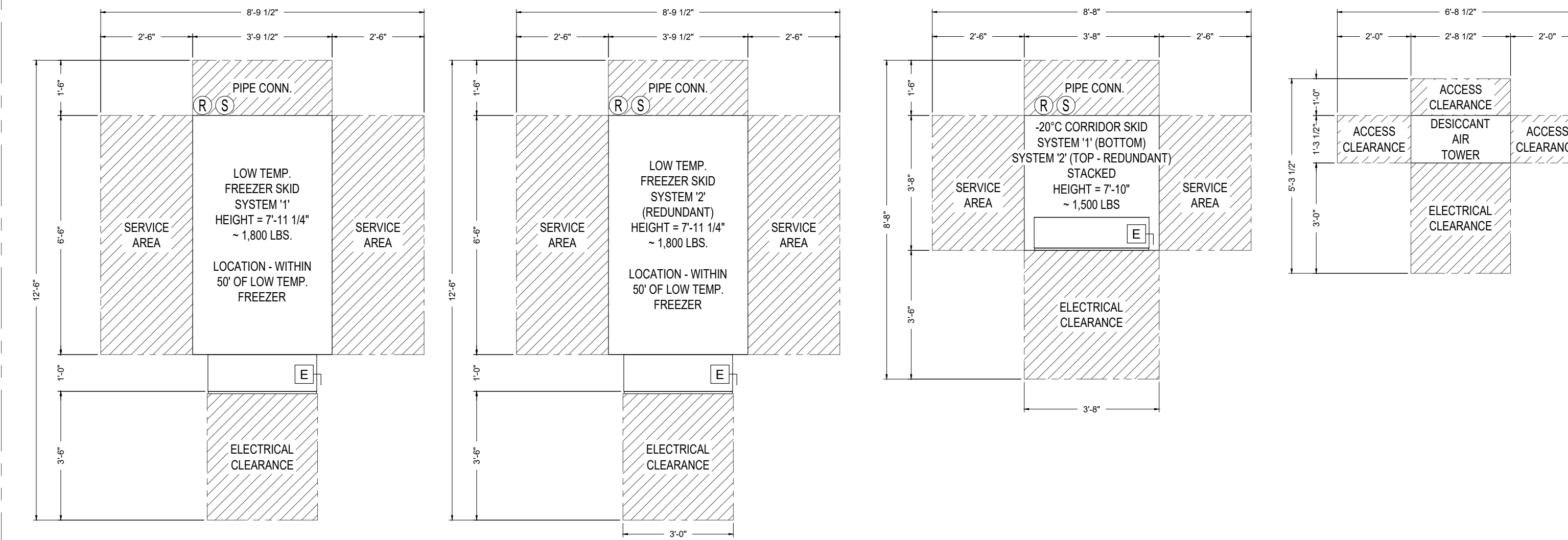

EQUIPMENT SIZE

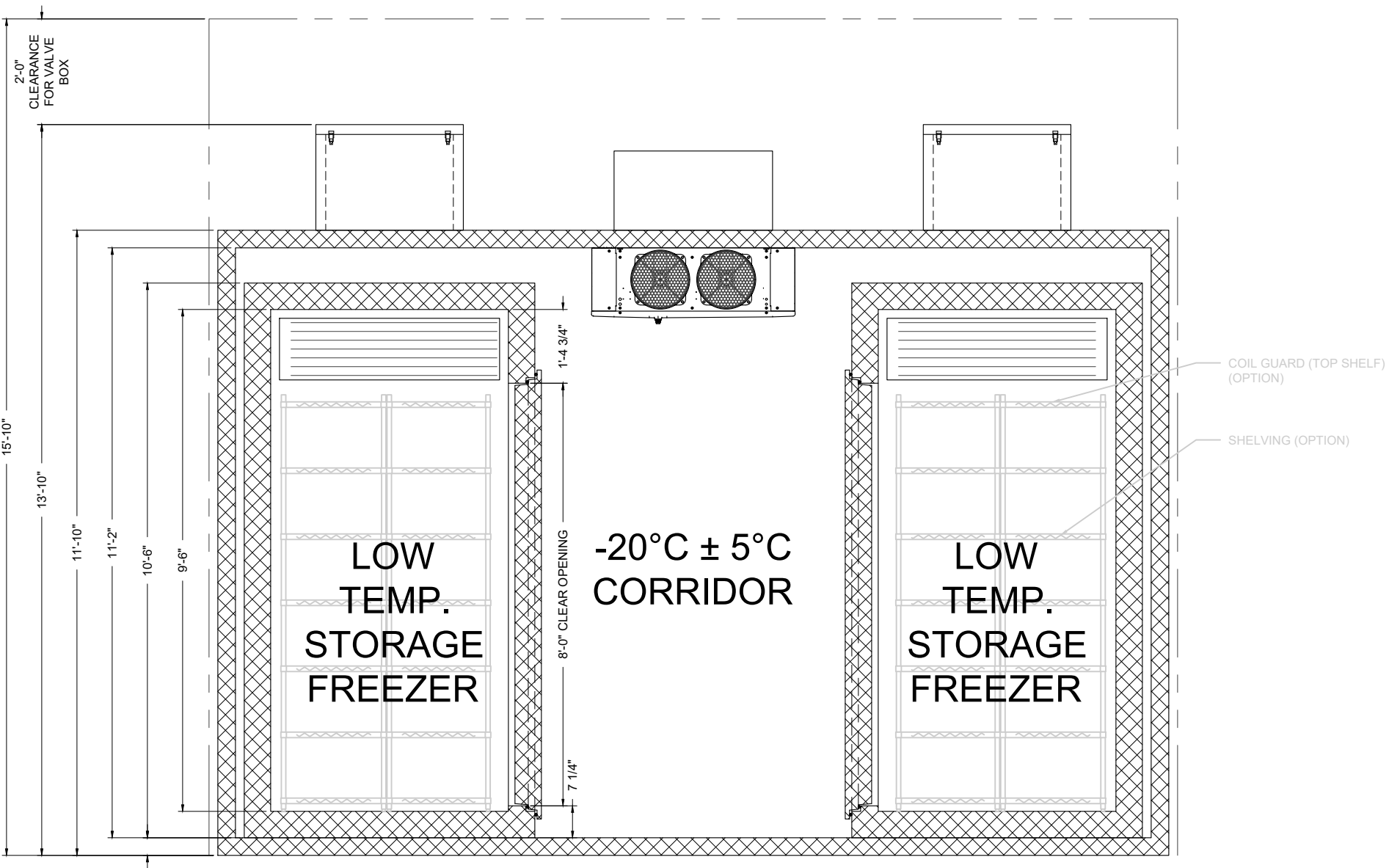

ELEVATION VIEW

NOT APPROVED FOR
CONSTRUCTION